

## Simple Database table relationship setting and simple query

The presentation demonstrates setting a simple relationship between tables and developing a simple query. This presentation builds on the work of "Access\_365\_import\_sort" presentation.

### Materials

Access 365

Weather data import (after fall2020 Preuss modifications)

### Preuss

9/22/2020

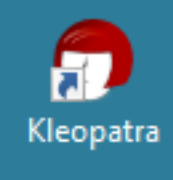
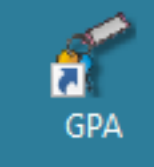
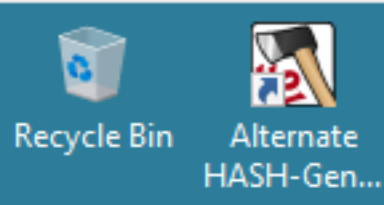

The presentation logs into Windows 10.

File Home Create External Data Database Tools

Compact and Repair Database Visual Basic Run Macro Relationships Object Dependencies Database Analyze P Analyze Ta

Tools Macro Relationships Relationships Ana

After opening the Access database with the appropriate data, the presentation selects "Database Tools".

The presentation selects "Relationships".

ID	LAT	LONG	STATE	NAME	GSN FLAG	HCN/CRN FL	WMO ID	Click to Add
8061	ASN00040708	-26.0336	151.0603	385	"HOME" MONOGORILBY			
7146	ASN00039031	-24.6486	150.745	404.8	"KAGEON" DAWES			
26532	CA003050PPF	51.7	-116.4667	2080	AB			
64807	US1INDL0025	40.0851	-85.3488	315.8	IN			
64746	US1INCL0015	40.2718	-86.6224	256.9	IN			
65604	US1INRN0008	40.1926	-85.199	311.5	IN			
64757	US1INCS0013	40.8054	-86.3858	228.9	IN			
65297	US1INLW0021	38.9277	-86.3755	199.9	IN			
64826	US1INDR0010	39.1064	-84.8794	258.5	IN			
65325	US1INMG0023	39.5128	-86.6418	246.3	IN			
64803	US1INDL0021	40.2268	-85.3705	290.5	IN			
64808	US1INDL0026	40.0844	-85.3447	317.6	IN			
65600	US1INRN0004	40.2583	-84.9746	311.8	IN			
65047	US1INHW0018	40.4326	-86.1844	255.7	IN			
65696	US1INTN0009	40.2969	-86.0574	267	IN			
64937	US1INGR0023	40.3885	-85.505	268.2	IN			
65241	US1INLK0096	41.5417	-87.327	0	IN			
64828	US1INDR0012	39.2367	-84.8619	282.9	IN			
64786	US1INDK0006	41.3652	-85.0436	264.9	IN			
64665	US1INBL0011	40.4619	-85.3729	282.5	IN			
65276	US1INLP0051	41.5919	-86.7415	249.9	IN			
64809	US1INDL0027	40.1901	-85.391	288.6	IN			
64782	US1INDC0006	39.2909	-85.5719	267.6	IN			
64940	US1INGR0026	40.4941	-85.6065	259.7	IN			
65586	US1INPT0125	41.4132	-87.0392	225.9	IN			
65690	US1INST0010	41.1803	-86.8327	216.4	IN			
64802	US1INDL0020	40.178	-85.502	275.5	IN			
65298	US1INLW0022	38.9232	-86.5339	187.8	IN			
65797	US1INWN0016	39.8888	-84.9364	0	IN			
65631	US1INSH0020	39.5869	-85.8661	236.2	IN			
65351	US1INMN0020	39.0289	-86.4376	176.8	IN			

Tools Relationships

Edit Relationships | Clear Layout | Relationship Report

Add Tables | Hide Table | Direct Relationships | All Relationships | Close

All Access Objects

Search...

Tables

- stationid
- Table1
- UCM00078988
- UG000063654

Table1 | stationid | Relationships

stationid
ID1
ID
LATITUDE
LONGITUDE
ELEVATION
STATE

UCM00078988
ID1
ID
YEAR
MONTH
ELEMENT
VALUE1

The presentation opens the "stationid" table and one other table as shown. The "add" button will add the highlighted table as shown.

Show Table

Tables | Queries | Both

- stationid
- Table1
- UCM00078988
- UG000063654

Add Close

Tools Relationships

- Edit Relationships
- Relationship Report
- Clear Layout
- Add Tables
- Hide Table
- Direct Relationships
- All Relationships
- Close

All Access Objects

- Search...
- Tables
- stationid
  - Table1
  - UCM00078988
  - UG000063654

Table1 | stationid | Relationships

stationid	
ID1	
ID	
LATITUDE	
LONGITUDE	
ELEVATION	
STATE	
NAME	
GSN FLAG	
HCN/CRN FLAG	
WMO ID	

UCM00078988	
ID1	
ID	
YEAR	
MONTH	
ELEMENT	
VALUE1	
MFLAG1	
QFLAG1	
SFLAG1	
VALUE2	
MFLAG2	
QFLAG2	
SFLAG2	
VALUE3	
MFLAG3	
QFLAG3	
SFLAG3	
VALUE4	
MFLAG4	
QFLAG4	
SFLAG4	
VALUE5	
MFLAG5	
QFLAG5	
SFLAG5	
VALUE6	

The presentation resizes the tables to make things a bit easier.

Tools

- Edit Relationships
- Relationship Report
- Clear Layout
- Add Tables
- Direct Relationships
- All Relationships
- Hide Table
- Close

All Access Objects

- Search...
- Tables
- stationid
  - Table1
  - UCM00078988
  - UG000063654

Table1 | stationid | Relationships

stationid	
ID1	
ID	
LATITUDE	
LONGITUDE	
ELEVATION	
STATE	
NAME	
GSN FLAG	
HCN/CRN FLAG	
WMO ID	

The presentation selects the "ID" field in the "stationid" table.

UCM00078988	
ID1	
ID	
YEAR	
MONTH	
ELEMENT	
VALUE1	
MFLAG1	
QFLAG1	
SFLAG1	
VALUE2	
MFLAG2	
QFLAG2	
SFLAG2	
VALUE3	
MFLAG3	
QFLAG3	
SFLAG3	
VALUE4	
MFLAG4	
QFLAG4	
SFLAG4	
VALUE5	
MFLAG5	
QFLAG5	
SFLAG5	
VALUE6	

While holding down the right mouse button, the presentation drags the mouse from "stationid" "ID" to "ID" in the other table.

Tools: Edit Relationships, Relationship Report, Add Tables, Hide Table, Direct Relationships, All Relationships, Close

All Access Objects | Tables: stationid, Table1, UCM00078988, UG000063654

stationid table fields: ID1, ID, LATITUDE, LONGITUDE, ELEVATION, STATE, NAME, GSN FLAG, HCN/CRN FLAG, WMO ID

UCM00078988 table fields: ID1, ID, YEAR, MONTH, MFLAG4, QFLAG4, SFLAG4, VALUE5, MFLAG5, QFLAG5, SFLAG5, VALUE6

Edit Relationships dialog box showing relationship between stationid and UCM00078988 on the ID field.

The presentation selects "Create" to continue.

Tools: Edit Relationships, Relationship Report, Add Tables, Hide Table, Direct Relationships, All Relationships, Close

The presentation sees the graphical representation of the relationship is correct.  
The presentation selects "Close".

- stationid
- Table1
- UCM00078988
- UG000063654

stationid
ID1
ID
LATITUDE
LONGITUDE
ELEVATION
STATE
NAME
GSN FLAG
HCN/CRN FLAG
WMO ID



UCM00078988
ID1
ID
YEAR
MONTH
ELEMENT
VALUE1
MFLAG1
QFLAG1
SFLAG1
VALUE2
MFLAG2
QFLAG2
SFLAG2
VALUE3
MFLAG3
QFLAG3
SFLAG3
VALUE4
MFLAG4
QFLAG4
SFLAG4
VALUE5
MFLAG5
QFLAG5
SFLAG5
VALUE6



Tools Relationships

Tools: Edit Relationships, Clear Layout, Relationship Report

Relationships: Add Tables, Hide Table, Direct Relationships, All Relationships, Close

All Access Objects

- Search...
- Tables
- stationid
  - Table1
  - UCM00078988
  - UG000063654

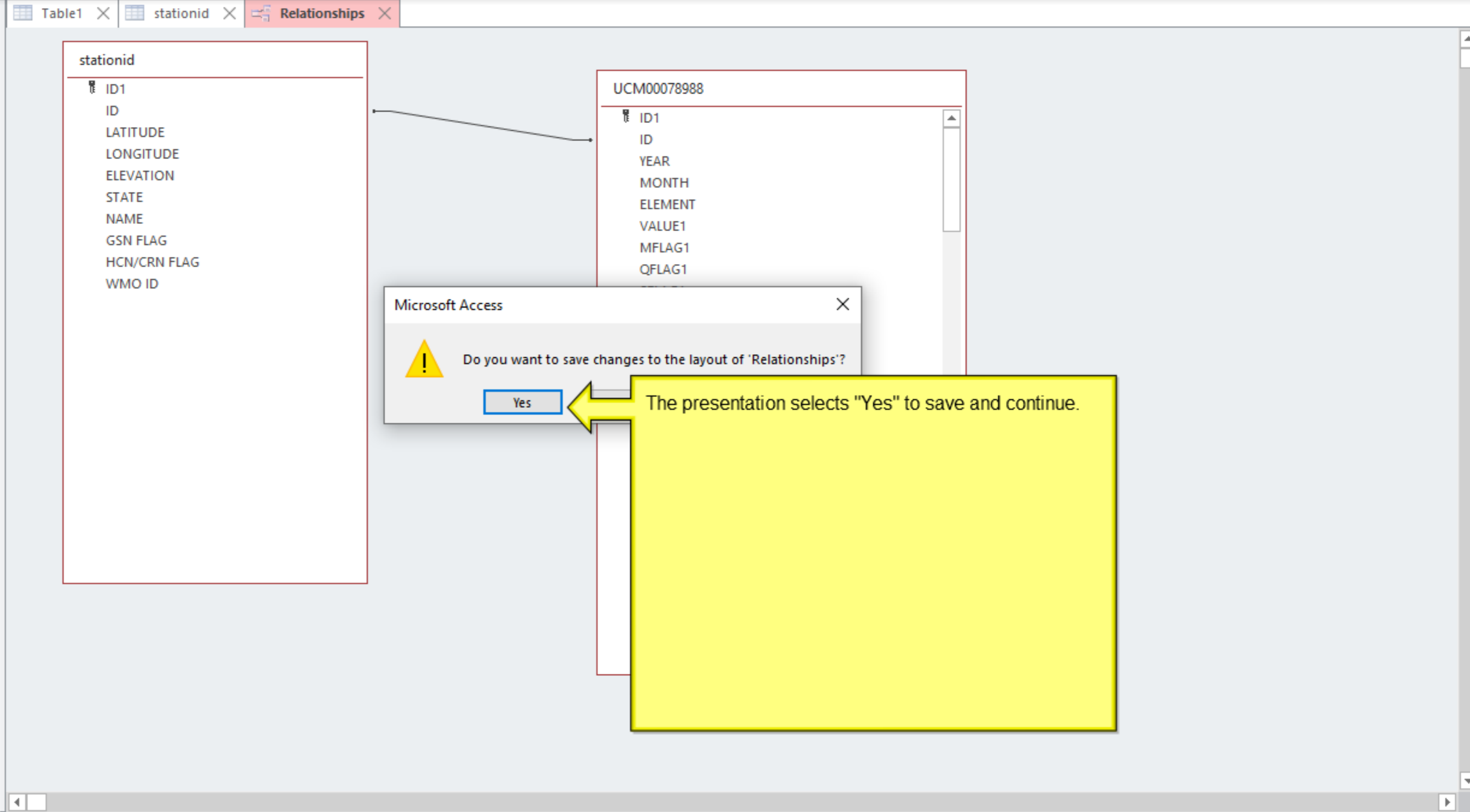

Microsoft Access

Do you want to save changes to the layout of 'Relationships'?

Yes

The presentation selects "Yes" to save and continue.

File Home **Create**

Application Parts | Table | Table Design | SharePoint Lists

Templates | Tables

The presentation selects the "Create" tab to continue.

All Access Objects

Search...

Tables

- stationid
- Table1
- UCM00078988
- UG000063654

STATE	NAME	GSN FLAG	HCN/CRN FL	WMO ID	Click to Add
35	"HOME" MONOGORILBY				
.8	"KAGEON" DAWES				
80 AB	(AE) BOW SUMMIT				
.8 IN	(K9CJC) SPRINGPORT 3.5 NE				
.9 IN	(K9DGS) MULBERRY 5.6 SSE				
.5 IN	(K9EKP) PARKER CITY 0.3 NE				
	(K9EQT) LOGANSPORT 3.9 NN				
	(K9GBR) BEDFORD 7.7 NE				
	(K9GPS) LAWRENCEBURG 0.7				
	(K9OJS) CLOVERDALE 8.4 E				
	(K9SJI/WA9KWL) MUNCIE 2.3				
	(K9TKO) SPRINGPORT 3.6 NE				
	(K9UZZ) SARATOGA 3.4 WNW				
	(K9VEZ) INDIAN HEIGHTS 3.6				
	(K9WKK) TIPTON 1.3 NW				
	(KA9FDN) MATTHEWS 0.4 WM				
	(KA9GKT) GARY 3.8 SSE				
	(KA9OOO) BRIGHT 2.4 N				
	(KA9RVJ) AUBURN 0.7 E				
	(KA9VIS) HARTFORD CITY 0.7				
	(KA9WNQ) LA PORTE 1.7 SW				
	(KB7ZGB) MUNCIE 0.5 S				
	(KB9CIY) GREENSBURG 6.0 SW				
	(KB9CRA) GAS CITY 0.3 N				
	(KB9F) VALPARAISO 4.5 S				
	(KB9GPW) NORTH JUDSON 3.9				
	(KB9IVB) YORKTOWN 1.3 WN				
	(KB9LGS) OOLITIC 2.2 N				
	(KB9MYL) RICHMOND 4.9 NN				
	(KB9RBB) FAIRLAND 0.9 SSW				
	(KB9RNB) BLOOMINGTON 10.				

Application Parts ▾  
 Templates

Table  
 Table Design  
 Tables

SharePoint Lists ▾  
 Tables

Query Wizard  
 Queries

Query Design  
 Queries

The presentation selects "Query Wizard".

All Access Obj... <<

Search...

Tables

- stationid
- Table1
- UCM00078988
- UG000063654

ID1	NAME	DATE	NAME	GSN FLAG	HCN/CRN FL	WMO ID	Click to Add
8061	ASN00040708	-26.0336	151.0603	385			"HOME" MONOGORILBY
7146	ASN00039031	-24.6486	150.745	404.8			"KAGEON" DAWES
26532	CA003050PPF	51.7	-116.4667	2080	AB		(AE) BOW SUMMIT
64807	US1INDL0025	40.0851	-85.3488	315.8	IN		(K9CJC) SPRINGPORT 3.5 NE
64746	US1INCL0015	40.2718	-86.6224	256.9	IN		(K9DGS) MULBERRY 5.6 SSE
65604	US1INRN0008	40.1926	-85.199	311.5	IN		(K9EKP) PARKER CITY 0.3 NE
64757	US1INCS0013	40.8054	-86.3858	228.9	IN		(K9EQT) LOGANSPORT 3.9 NN
65297	US1INLW0021	38.9277	-86.3755	199.9	IN		(K9GBR) BEDFORD 7.7 NE
64826	US1INDR0010	39.1064	-84.8794	258.5	IN		(K9GPS) LAWRENCEBURG 0.7
65325	US1INMG0023	39.5128	-86.6418	246.3	IN		(K9QIS) CLOVERDALE 8.4 E
64803	US1INDL0021						
64808	US1INDL0026						
65600	US1INRN0004						
65047	US1INHW0018						
65696	US1INTN0009						
64937	US1INGR0023						
65241	US1INLK0096	41.5417	-87.327	0	IN		
64828	US1INDR0012	39.2367	-84.8619	282.9	IN		
64786	US1INDK0006	41.3652	-85.0436	264.9	IN		
64665	US1INBL0011	40.4619	-85.3729	282.5	IN		
65276	US1INLP0051	41.5919	-86.7415	249.9	IN		
64809	US1INDL0027	40.1901	-85.391	288.6	IN		
64782	US1INDC0006	39.2909	-85.5719	267.6	IN		
64940	US1INGR0026	40.4941	-85.6065	259.7	IN		
65586	US1INPT0125	41.4132	-87.0392	225.9	IN		
65690	US1INST0010	41.1803	-86.8327	216.4	IN		
64802	US1INDL0020	40.178	-85.502	275.5	IN		
65298	US1INLW0022	38.9232	-86.5339	187.8	IN		
65797	US1INWN0016	39.8888	-84.9364	0	IN		(KB9MYL) RICHMOND 4.9 NN
65631	US1INSH0020	39.5869	-85.8661	236.2	IN		(KB9RBB) FAIRLAND 0.9 SSW
65351	US1INMN0020	39.0289	-86.4376	176.8	IN		(KB9RNB) BLOOMINGTON 10.

Microsoft Access

**You must save the table 'stationid' before you can create a new object based on it.**

Do you want to save the table 'stationid' and create a new object?

Yes

The presentation selects "Yes" to save the data.

File Home **Create** External Data Database Tools Help Fields Table Tell me what you want to do

Application Parts | Table | Table Design | SharePoint Lists | Query Wizard | Query Design | Form | Form Design | Blank Form | Navigation | More Forms | Report | Report Design | Blank Report | Labels | Macro | Module | Class Module | Visual Basic

Templates | Tables | Queries | Forms | Reports | Macros & Code

All Access Objects

Search...

Tables

- stationid
- Table1
- UCM00078988
- UG000063654

ID1	ID	LATITUDE	LONGITUDE	ELEVATION	STATE	NAME	GSN FLAG	HCN/CRN FL	WMO ID	Click to Add
8061	ASN00040708	-26.0336								
7146	ASN00039031	-24.6486								
26532	CA003050PPF	51.7								
64807	US1INDL0025	40.0851								
64746	US1INCL0015	40.2718								
65604	US1INRN0008	40.1926								
64757	US1INCS0013	40.8054								
65297	US1INLW0021	38.9277								
64826	US1INDR0010	39.1064								
65325	US1INMG0023	39.5128								
64803	US1INDL0021	40.2268								
64808	US1INDL0026	40.0844								
65600	US1INRN0004	40.2583								
65047	US1INHW0018	40.4326								
65696	US1INTN0009	40.2969								
64937	US1INGR0023	40.3885								
65241	US1INLK0096	41.5417								
64828	US1INDR0012	39.2367	-84.8619	282.9	IN	(KA9000)BRIGHT 2.4 N				
64786	US1INDK0006	41.3652	-85.0436	264.9	IN	(KA9RVJ)AUBURN 0.7 E				
64665	US1INBL0011	40.4619	-85.3729	282.5	IN	(KA9VIS) HARTFORD CITY 0.7				
65276	US1INLP0051	41.5919	-86.7415	249.9	IN	(KA9WNQ)LA PORTE 1.7 SW				
64809	US1INDL0027	40.1901	-85.391	288.6	IN	(KB7ZGB) MUNCIE 0.5 S				
64782	US1INDC0006	39.2909	-85.5719	267.6	IN	(KB9CIY)GREENSBURG 6.0 SW				
64940	US1INGR0026	40.4941	-85.6065	259.7	IN	(KB9CRA)GAS CITY 0.3 N				
65586	US1INPT0125	41.4132	-87.0392	225.9	IN	(KB9F)VALPARAISO 4.5 S				
65690	US1INST0010	41.1803	-86.8327	216.4	IN	(KB9GPW)NORTH JUDSON 3.9				
64802	US1INDL0020	40.178	-85.502	275.5	IN	(KB9IVB) YORKTOWN 1.3 WN				
65298	US1INLW0022	38.9232	-86.5339	187.8	IN	(KB9LGS)OOLITIC 2.2 N				
65797	US1INWN0016	39.8888	-84.9364	0	IN	(KB9MYL)RICHMOND 4.9 NN				
65631	US1INSH0020	39.5869	-85.8661	236.2	IN	(KB9RBB)FAIRLAND 0.9 SSW				
65351	US1INMN0020	39.0289	-86.4376	176.8	IN	(KB9RNB)BLOOMINGTON 10.				

New Query

This wizard creates a select query from the fields you pick.

- Simple Query Wizard
- Crosstab Query Wizard
- Find Duplicates Query Wizard
- Find Unmatched Query Wizard

OK Cancel

The presentation selects "Simple Query Wizard", then "OK" to continue.

File Home Create External Data Database Tools Help Fields Table Tell me what you want to do

Application Parts, Tables, Queries, Forms, Reports, Macros & Code

All Access Objects

Tables: stationid, Table1, UCM00078988, UG000063654

ID1	ID	LATITUDE	LONGITUDE	NAME
8061	ASN00040708	-2		
7146	ASN00039031	-2		
26532	CA003050PPF			
64807	US1INDL0025	4		
64746	US1INCL0015	4		
65604	US1INRN0008	4		
64757	US1INCS0013	4		
65297	US1INLW0021	3		
64826	US1INDR0010	3		
65325	US1INMG0023	3		
64803	US1INDL0021	4		
64808	US1INDL0026	4		
65600	US1INRN0004	4		
65047	US1INHW0018	4		
65696	US1INTN0009	4		
64937	US1INGR0023	4		
65241	US1INLK0096	41.5417	-87.327	0 IN (KA9GKT) G...
64828	US1INDR0012	39.2367	-84.8619	282.9 IN (KA9000)E...
64786	US1INDK0006	41.3652	-85.0436	264.9 IN (KA9RVJ)AL...
64665	US1INBL0011	40.4619	-85.3729	282.5 IN (KA9VIS) HARTFORD CITY 0.7
65276	US1INLP0051	41.5919	-86.7415	249.9 IN (KA9WNQ)LA PORTE 1.7 SW
64809	US1INDL0027	40.1901	-85.391	288.6 IN (KB7ZGB) MUNCIE 0.5 S
64782	US1INDC0006	39.2909	-85.5719	267.6 IN (KB9CIY)GREENSBURG 6.0 SW
64940	US1INGR0026	40.4941	-85.6065	259.7 IN (KB9CRA)GAS CITY 0.3 N
65586	US1INPT0125	41.4132	-87.0392	225.9 IN (KB9F)VALPARAISO 4.5 S
65690	US1INST0010	41.1803	-86.8327	216.4 IN (KB9GPW)NORTH JUDSON 3.9
64802	US1INDL0020	40.178	-85.502	275.5 IN (KB9IVB) YORKTOWN 1.3 WN
65298	US1INLW0022	38.9232	-86.5339	187.8 IN (KB9LGS)OOLITIC 2.2 N
65797	US1INWN0016	39.8888	-84.9364	0 IN (KB9MYL)RICHMOND 4.9 NN
65631	US1INSH0020	39.5869	-85.8661	236.2 IN (KB9RBB)FAIRLAND 0.9 SSW
65351	US1INMN0020	39.0289	-86.4376	176.8 IN (KB9RNB)BLOOMINGTON 10.

Simple Query Wizard

Which fields do you want in your query?  
You can choose from more than one table or query.

Tables/Queries: Table: stationid

Available Fields: ID1, ELEVATION, STATE, GSN FLAG, HCN/CRN FLAG, WMO ID

Selected Fields: ID, LATITUDE, LONGITUDE, NAME

Buttons: Cancel, < Back, Next >

The presentation selects the table "stationid". Under the fields, the presentation selects "ID", "LATITUDE", "LONGITUDE" and "NAME".

The presentation changes tables for the next step.

File Home Create External Data Database Tools Help Fields Table Tell me what you want to do

Application Parts, Tables, Queries, Forms, Reports, Macros & Code

All Access Obj...

Search...

Tables

- stationid
- Table1
- UCM00078988
- UG000063654

ID1	ID	LATITUDE	LONGITUDE	NAME	YEAR	MONTH	ELEMENT
8061	ASN00040708	-2					
7146	ASN00039031	-2					
26532	CA003050PPF						
64807	US1INDL0025	4					
64746	US1INCL0015	4					
65604	US1INRN0008	4					
64757	US1INCS0013	4					
65297	US1INLW0021	3					
64826	US1INDR0010	3					
65325	US1INMG0023	3					
64803	US1INDL0021	4					
64808	US1INDL0026	4					
65600	US1INRN0004	4					
65047	US1INHW0018	4					
65696	US1INTN0009	4					
64937	US1INGR0023	4					
65241	US1INLK0096	41.5417	-87.327	0 IN			(KA9GKT) C
64828	US1INDR0012	39.2367	-84.8619	282.9 IN			(KA9000)
64786	US1INDK0006	41.3652	-85.0436	264.9 IN			(KA9RVJ)A
64665	US1INBL0011	40.4619	-85.3729	282.5 IN			(KA9VIS) HARTFORD CITY 0.7
65276	US1INLP0051	41.5919	-86.7415	249.9 IN			(KA9WNQ)LA PORTE 1.7 SW
64809	US1INDL0027	40.1901	-85.391	288.6 IN			(KB7ZGB) MUNCIE 0.5 S
64782	US1INDC0006	39.2909	-85.5719	267.6 IN			(KB9CIY)GREENSBURG 6.0 SW
64940	US1INGR0026	40.4941	-85.6065	259.7 IN			(KB9CRA)GAS CITY 0.3 N
65586	US1INPT0125	41.4132	-87.0392	225.9 IN			(KB9F)VALPARAISO 4.5 S
65690	US1INST0010	41.1803	-86.8327	216.4 IN			(KB9GPW)NORTH JUDSON 3.9
64802	US1INDL0020	40.178	-85.502	275.5 IN			(KB9IVB) YORKTOWN 1.3 WN
65298	US1INLW0022	38.9232	-86.5339	187.8 IN			(KB9LGS)OOLITIC 2.2 N
65797	US1INWN0016	39.8888	-84.9364	0 IN			(KB9MYL)RICHMOND 4.9 NN
65631	US1INSH0020	39.5869	-85.8661	236.2 IN			(KB9RBB)FAIRLAND 0.9 SSW
65351	US1INMN0020	39.0289	-86.4376	176.8 IN			(KB9RNB)BLOOMINGTON 10.

Simple Query Wizard

Which fields do you want in your query?  
You can choose from more than one table or query.

Tables/Queries  
Table: UCM00078988

Available Fields:  
ID1, ID, VALUE1, MFLAG1, QFLAG1, SFLAG1, VALUE2, MFLAG2

Selected Fields:  
ID, LATITUDE, LONGITUDE, NAME, YEAR, MONTH, ELEMENT

Buttons: Cancel, < Back, Next >

The presentation changes the table to the name in the relationship. The presentation adds "YEAR", "MONTH" and "ELEMENT" for the second table.

Now, the presentation selects "Next" to continue.

File Home Create External Data Database Tools Help Fields Table Tell me what you want to do

Application Parts | Table | Table Design | SharePoint Lists | Query Wizard | Query Design | Form | Form Design | Blank Form | Navigation | More Forms | Report | Report Design | Blank Report | Labels | Macro | Module | Class Module | Visual Basic

Templates | Tables | Queries | Forms | Reports | Macros & Code

All Access Objects

Search...

Tables

- stationid
- Table1
- UCM00078988
- UG000063654

ID1	ID	LATITUDE	LONGITUDE	IN	NAME
8061	ASN00040708	-2			
7146	ASN00039031	-2			
26532	CA003050PPF				
64807	US1INDL0025	4			
64746	US1INCL0015	4			
65604	US1INRN0008	4			
64757	US1INCS0013	4			
65297	US1INLW0021	3			
64826	US1INDR0010	3			
65325	US1INMG0023	3			
64803	US1INDL0021	4			
64808	US1INDL0026	4			
65600	US1INRN0004	4			
65047	US1INHW0018	4			
65696	US1INTN0009	4			
64937	US1INGR0023	4			
65241	US1INLK0096	41.5417	-87.327	0	IN (KA9GKT) GARY 3.8 SSE
64828	US1INDR0012	39.2367	-84.8619	282.9	IN (KA9000) BRIGHT 2.4 N
64786	US1INDK0006	41.3652	-85.0436	264.9	IN (KA9RVJ) AUBURN 0.7 E
64665	US1INBL0011	40.4619	-85.3729	282.5	IN (KA9VIS) HARTFORD CITY 0.7
65276	US1INLP0051	41.5919	-86.7415	249.9	IN (KA9WNQ) LA PORTE 1.7 SW
64809	US1INDL0027	40.1901	-85.391	288.6	IN (KB7ZGB) MUNCIE 0.5 S
64782	US1INDC0006	39.2909	-85.5719	267.6	IN (KB9CIY) GREENSBURG 6.0 SW
64940	US1INGR0026	40.4941	-85.6065	259.7	IN (KB9CRA) GAS CITY 0.3 N
65586	US1INPT0125	41.4132	-87.0392	225.9	IN (KB9F) VALPARAISO 4.5 S
65690	US1INST0010	41.1803	-86.8327	216.4	IN (KB9GPW) NORTH JUDSON 3.9
64802	US1INDL0020	40.178	-85.502	275.5	IN (KB9IVB) YORKTOWN 1.3 WN
65298	US1INLW0022	38.9232	-86.5339	187.8	IN (KB9LGS) OOLITIC 2.2 N
65797	US1INWN0016	39.8888	-84.9364	0	IN (KB9MYL) RICHMOND 4.9 NN
65631	US1INSH0020	39.5869	-85.8661	236.2	IN (KB9RBB) FAIRLAND 0.9 SSW
65351	US1INMN0020	39.0289	-86.4376	176.8	IN (KB9RNB) BLOOMINGTON 10.0

Simple Query Wizard

Would you like a detail or summary query?

Detail (shows every field of every record)

Summary

Summary Options ...

Cancel < Back Next > Finish

The presentation selects "Detail", then "Next" to continue.

File Home Create External Data Database Tools Help Fields Table Tell me what you want to do

Application Parts | Table | Table Design | SharePoint Lists | Query Wizard | Query Design | Form | Form Design | Blank Form | Navigation | More Forms | Report | Report Design | Blank Report | Labels | Macro | Module | Class Module | Visual Basic

Templates | Tables | Queries | Forms | Reports | Macros & Code

All Access Objects

Search...

Tables

- stationid
- Table1
- UCM00078988
- UG000063654

ID1	ID	LATITUDE	LONGITUDE	IN	NAME
8061	ASN00040708	-2			
7146	ASN00039031	-2			
26532	CA003050PPF				
64807	US1INDL0025	4			
64746	US1INCL0015	4			
65604	US1INRN0008	4			
64757	US1INCS0013	4			
65297	US1INLW0021	3			
64826	US1INDR0010	3			
65325	US1INMG0023	3			
64803	US1INDL0021	4			
64808	US1INDL0026	4			
65600	US1INRN0004	4			
65047	US1INHW0018	4			
65696	US1INTN0009	4			
64937	US1INGR0023	4			
65241	US1INLK0096	41.5417	-87.327	0	IN (KA9GKT) GARY 3.8 SSE
64828	US1INDR0012	39.2367	-84.8619	282.9	IN (KA9000) BRIGHT 2.4 N
64786	US1INDK0006	41.3652	-85.0436	264.9	IN (KA9RVJ) AUBURN 0.7 E
64665	US1INBL0011	40.4619	-85.3729	282.5	IN (KA9VIS) HARTFORD CITY 0.7
65276	US1INLP0051	41.5919	-86.7415	249.9	IN (KA9WNQ) LA PORTE 1.7 SW
64809	US1INDL0027	40.1901	-85.391	288.6	IN (KB7ZGB) MUNCIE 0.5 S
64782	US1INDC0006	39.2909	-85.5719	267.6	IN (KB9CIY) GREENSBURG 6.0 SW
64940	US1INGR0026	40.4941	-85.6065	259.7	IN (KB9CRA) GAS CITY 0.3 N
65586	US1INPT0125	41.4132	-87.0392	225.9	IN (KB9F) VALPARAISO 4.5 S
65690	US1INST0010	41.1803	-86.8327	216.4	IN (KB9GPW) NORTH JUDSON 3.9
64802	US1INDL0020	40.178	-85.502	275.5	IN (KB9IVB) YORKTOWN 1.3 WN
65298	US1INLW0022	38.9232	-86.5339	187.8	IN (KB9LGS) OOLITIC 2.2 N
65797	US1INWN0016	39.8888	-84.9364	0	IN (KB9MYL) RICHMOND 4.9 NN
65631	US1INSH0020	39.5869	-85.8661	236.2	IN (KB9RBB) FAIRLAND 0.9 SSW
65351	US1INMN0020	39.0289	-86.4376	176.8	IN (KB9RNB) BLOOMINGTON 10.0

Simple Query Wizard

What title do you want for your query?  
stationid Query 01

That's all the information the wizard needs to create your query.

Do you want to open the query or modify the query's design?

Open the query to view information.  
 Modify the query design.

Cancel < Back Next > Finish

The presentation changes the query name, then selects "Finish" to continue.



File Home **Create** External Data Database Tools Help Tell me what you want to do

Application Parts, Tables, Queries, Forms, Reports, Macros & Code

All Access Objects

Tables: stationid, Table1, UCM00078988, UG000063654

Queries: stationid Query 01

ID	LATITUDE	LONGITUDE	NAME	YEAR	MONTH	ELEMENT
UCM00078988	12.189	-68.96	HATO	1942	9	TAVG
UCM00078988	12.189	-68.96	HATO	1942	10	TAVG
UCM00078988	12.189	-68.96	HATO	1942	11	TAVG
UCM00078988	12.189	-68.96	HATO	1942	12	TAVG
UCM00078988	12.189	-68.96	HATO	1943	1	TAVG
UCM00078988	12.189	-68.96	HATO	1943	2	TAVG
UCM00078988	12.189	-68.96	HATO	1943	3	TAVG
UCM00078988	12.189	-68.96	HATO	1943	4	TAVG
UCM00078988	12.189	-68.96	HATO	1943	5	TAVG
UCM00078988	12.189	-68.96	HATO	1943	6	TAVG
UCM00078988	12.189	-68.96	HATO	1943	7	TAVG
UCM00078988	12.189	-68.96	HATO	1943	8	TAVG
UCM00078988	12.189	-68.96	HATO	1943	9	TAVG
UCM00078988	12.189	-68.96	HATO	1943	10	TAVG
UCM00078988	12.189	-68.96	HATO	1943	11	TAVG
UCM00078988	12.189	-68.96	HATO	1943	12	TAVG
UCM00078988	12.189	-68.96	HATO	1944	1	TAVG
UCM00078988	12.189	-68.96	HATO	1944	2	TAVG
UCM00078988	12.189	-68.96	HATO	1944	3	TAVG
UCM00078988	12.189	-68.96	HATO	1944	4	TAVG
UCM00078988	12.189	-68.96	HATO	1944	5	TAVG
UCM00078988	12.189	-68.96	HATO	1944	6	TAVG
UCM00078988	12.189	-68.96	HATO	1944	7	TAVG
UCM00078988	12.189	-68.96	HATO	1944	8	TAVG
UCM00078988	12.189	-68.96	HATO	1944	9	TAVG
UCM00078988	12.189	-68.96	HATO	1944	10	TAVG
UCM00078988	12.189	-68.96	HATO	1944	11	TAVG
UCM00078988	12.189	-68.96	HATO	1944	12	TAVG
UCM00078988	12.189	-68.96	HATO	1945	1	TAVG
UCM00078988	12.189	-68.96	HATO	1945	2	TAVG
UCM00078988	12.189	-68.96	HATO	1945	3	TAVG

Data from both tables is found in the query result.